

Aluminum Terminals

Types RAA and RAAC

For aluminum tube to flat

- Manufactured from high strength cast aluminum alloy
- Clamping hardware is of high strength, anodized and lubricated 2024-T4 aluminum alloy
- Side formed contact surfaces are standard to allow clearance for flush mounting
- Oxide inhibitor recommended on contact surfaces
- Captive bolt head design permits single wrench installation
- Drilling in pads conforms to NEMA standards for 1/2" hardware
- Special drilling is available upon request
- If copper flashed pad is preferred on tongue, use "RAAC" prefix
- For tin plating, suffix catalog number with "-TN"
- For tongue mounting hardware, suffix catalog number with "-TMH"

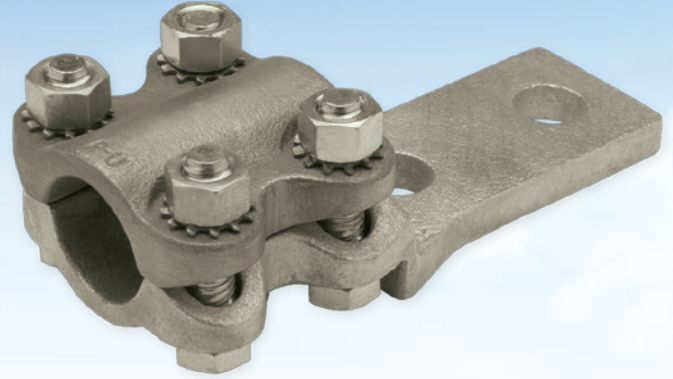

CATALOG NUMBER	A ALUMINUM IPS	APPROXIMATE DIMENSIONS (IN.)					BOLT SIZE
		G	L	M	T	W	
RAA-07-D	3/4	1.19	6.50	3.25	.44	2.63	1/2
RAA-07-F		1.19	6.50	3.25	.44	2.63	1/2
RAA-10-D	1	1.31	6.75	3.50	.44	3.00	1/2
RAA-10-F		1.31	6.75	3.50	.44	3.00	1/2
RAA-12-D	1 1/4	1.56	7.00	3.75	.50	3.56	5/8
RAA-12-F		1.56	7.00	3.75	.50	3.56	5/8
RAA-12-E		1.56	8.00	3.75	.44	3.56	5/8
RAA-15-D	1 1/2	1.44	7.25	4.00	.50	3.88	5/8
RAA-15-F		1.44	7.25	4.00	.50	3.88	1/2
RAA-15-E		1.44	8.25	4.00	.44	3.88	5/8
RAA-20-D	2	1.69	7.63	4.38	.56	4.44	5/8
RAA-20-F		1.69	7.63	4.38	.56	4.44	5/8
RAA-20-E		1.69	8.63	4.38	.44	4.44	5/8
RAA-25-D	2 1/2	2.19	8.00	4.75	.63	5.13	3/4
RAA-25-F		2.19	8.00	4.75	.63	5.13	3/4
RAA-25-E		2.19	9.00	4.75	.50	5.13	3/4
RAA-30-D	3	2.69	8.38	5.13	.75	5.75	3/4
RAA-30-F		2.69	8.38	5.13	.75	5.75	3/4
RAA-30-E		2.69	9.38	5.13	.75	5.75	3/4
RAA-35-D	3 1/2	3.19	8.75	5.50	1.06	6.81	7/8
RAA-35-F		3.19	8.75	5.50	1.06	6.81	7/8
RAA-35-E		3.19	9.75	5.50	1.06	6.81	7/8
RAA-40-D	4	3.44	9.13	5.88	1.19	7.81	7/8
RAA-40-F		3.44	9.13	5.88	1.19	7.81	7/8
RAA-40-E		3.44	10.13	5.88	1.19	7.81	7/8
RAA-50-E	5	3.75	10.75	6.50	1.31	8.94	7/8
RAA-60-E	6	4.25	11.75	7.50	1.75	10.06	7/8

